

**4** co-ed residence halls & 2 apartment buildings



Our residence halls foster community and diversity and make it easy to feel right at home. Your classes, dining, and recreation are right outside your front door.

**Cook Hall – \$1,350 per semester\***

Located near the Student Center, Cook Hall is the largest residence hall on campus. This hall is co-ed by floor and provides a lively atmosphere for students. Amenities include a large study room, full kitchen, community-style bathrooms, microwave access and laundry facilities on every floor, an elevator, a central recreational lounge, and internet. Rooms are furnished with beds, desks, chairs, closets, and dressers.

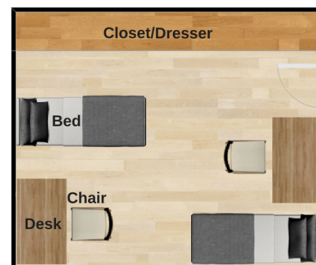

**Crane Hall – \$1,641 per semester\***

More centralized to academic buildings, Crane Hall is a co-ed, suite-style residence hall where two rooms share a bathroom facility. This hall provides a comfortable living environment while encouraging community and diversity among students. Amenities include a full kitchen, laundry facilities, and recreational lounges on every floor, an elevator, internet, and air conditioning. Rooms are carpeted and furnished with beds, desks, chairs, closets, and dressers.



**Lura Manor – \$1,641 per semester\***

Lura Manor is a co-ed and gender inclusive suite-style residence hall where two rooms share a bathroom facility. This hall offers students community, diversity, and a comfortable living environment. Amenities include study nooks, recreational lounges, and microwave access on every floor, kitchenettes, an elevator, internet, air conditioning, and three laundry facilities throughout the building. Rooms are furnished with beds, desks, chairs, closets, and dressers.

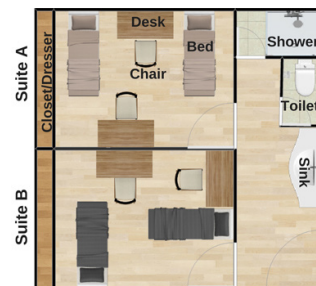

**McCulloch Hall – \$1,350 per semester\***

McCulloch Hall is co-ed by floor, and located near the Student Center. Amenities include laundry facilities, community-style bathrooms, microwave access on every floor, two recreational lounges, a kitchenette, and internet. Rooms are carpeted and furnished with beds, desks, chairs, closets, and dressers.

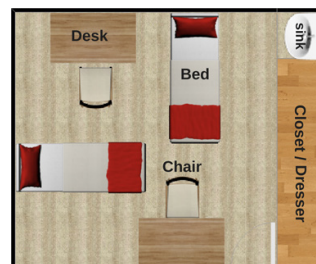

\*All room and board rates are based on double occupancy. 2020-2021 rates; subject to change.

[AskMSU.com/reslife](http://AskMSU.com/reslife)

*First-Year Live-On Policy: To promote your success, Minot State requires first-year students to live on campus in our residence halls.*

Be seen. Be heard. Belong.



## Why live on campus?

*"Living on campus has introduced me to some of my best friends. Through activities on campus I was able to meet some great people and get involved. Everyone at Minot State is so welcoming and living away from home it has given me a sense of belonging."*

Wyniah Mintz  
Hometown: Glendive, Montana

*"I love the community and family spirit that develops for the residents. I like that I get to meet new people every year, make new friends and establish connections."*

Praise Osagioduwa Okubur  
Hometown: Benin City, Nigeria

*"The best part about living on campus is the convenience. Everything is close and it is easy to be part of programs and school activities."*

Beverly Chigarira  
Hometown: Kadoma, Zimbabwe

*"I considered the cost of living in an apartment. I looked at the extra expenses of utilities, long leases, gas for my car, internet, and food, as well as having the time to cook the food, and realized that living on campus was a good financial decision."*

Sarah Waclawik  
Hometown: Fargo, ND



The housing application will open in February for accepted students. Find the policies at [AskMSU.com/reslife](http://AskMSU.com/reslife).



## Dining

Use your unlimited meal plan at Beaver Creek Café and enjoy a variety of cuisine choices every day of the week! All students living in the residence halls must have a meal plan.

### Meal Plan Options

**Unlimited Platinum**..... \$2,303/semester\*

*Includes \$120 Flex Dollars and 5 guest passes*

**Unlimited Gold** ..... \$2,251/semester\*

*Includes \$50 Flex Dollars and 3 guest passes*

\*All costs subject to change

[AskMSU.com/dining](http://AskMSU.com/dining)